

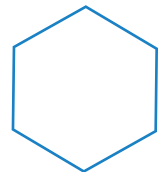

METAL CASEWORK

Installation Instructions



Contents

PAGE

1. 02 Required Tools

1. 03 Unpack

2. 03 Layout Elevations

03 Determine Countertop Height

04 Find Outermost Points Of Walls

04 Layout Wall Cabs

3. 05 Install Upper Wall Cabinets

4. 07 Install Base Cabinets

07 Cabinets

09 Aprons & knee panels

10 Pedestals

10 Sink supports

10 Rear Fillers

11 C-fillers

11 Corner fillers

5. 12 Install Countertops

6. 13 Final Alignment

13 Doors

1. Required Tools

Layout Tools

- Tape measure
- Box levels
- Laser or transit level
- Chalk line



- String line



- 2ft framing square



Power Tools

- Cordless drill
- Jigsaw with metal cutting blade
- Drill bit set
- Grinder with cutoff wheel
- Bi-metal hole saw
- Drill driver set



Hand Tools

- Cordless drill
- Wrench set
- Screwdriver
- Prybar
- Clamps



Supplies

- Wood or composite shimps
- Self-tapping sheet metal screws

1. Unpack

Unpack and distribute cabinets to their intended locations.

*We don't provide the installation hardware.

2. Layout Elevations

Perform these steps for every run of continuous countertops.

Determine Countertop Height

- 2.1.** Layout the rough locations of base cabinets along the wall based on intersecting walls and cabinet runs, obstructions, or other critical distances.
- 2.2.** Using a laser or transit level to scan the entire area of the run, determine the highest point in the floor. Include a zone roughly 30" out from the wall.
- 2.3.** From the highest point found, measure up to the top of the designed cabinet height and transfer this measurement to the wall in a few places.
- 2.4.** Use a chalk line or straightedge to connect the marks representing the top of cabinets along the wall.

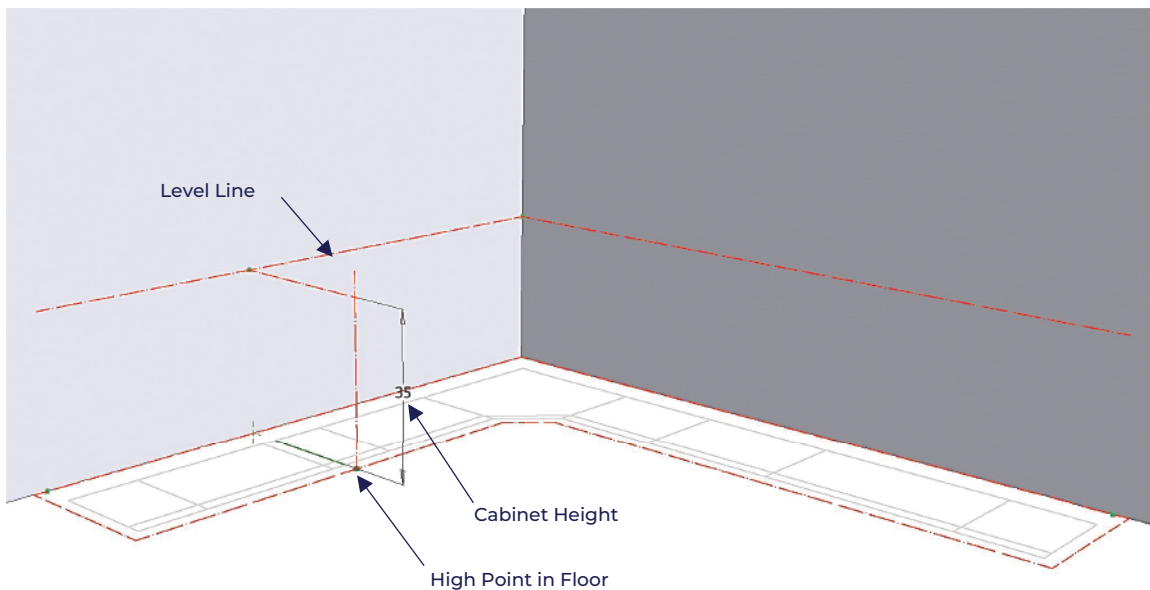

Find Outermost Points Of Walls

- 2.5.** Using a stringline or straightedge along the lines drawn in Step 2.4, locate any bumps in the wall at the countertop height. Mark the outermost point at the cabinet line.
- 2.6.** Use a plumb level to transfer this point to the floor. Then measure out roughly
- 2.7.** Draw a line parallel to the wall through this point.
- 2.8.** Repeat Steps **2.5 - 2.7** for any intersecting cabinet runs. Evaluate perpendicularity of intersecting lines and adjust either run as needed.
- 2.9.** Along the toekick lines defined in Step 2.7, layout endpoints and other critical alignment points. Transfer these to wall as well.

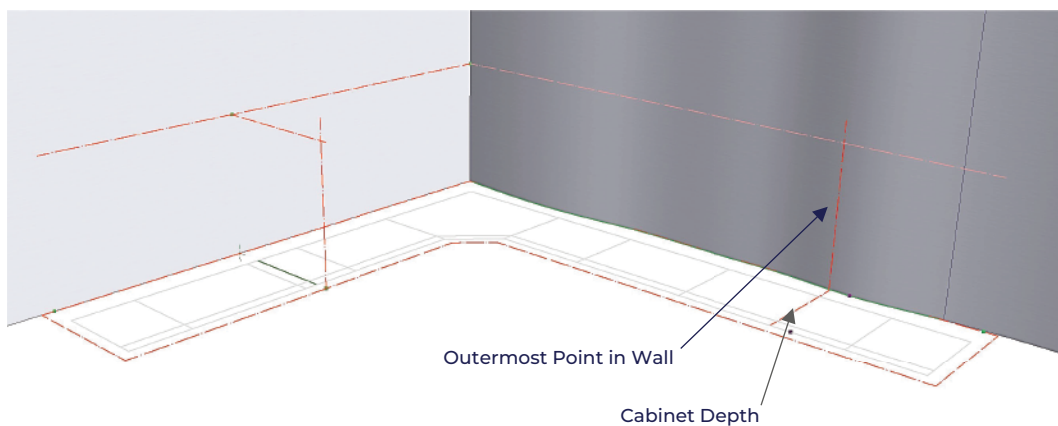

Layout Wall Cabinets

- 2.10.** Measure up from the T.O. cabinet line established in Step 2.4 to mark the tops of upper wall cabinets. Measure down 2" from this point to mark the screw line of the wall cabinet cleats. Use a level to extend this line horizontally as needed where wall cabinets are to be installed.
- 2.11.** Use a plumb level to transfer any critical alignment marks from Step 2.9.

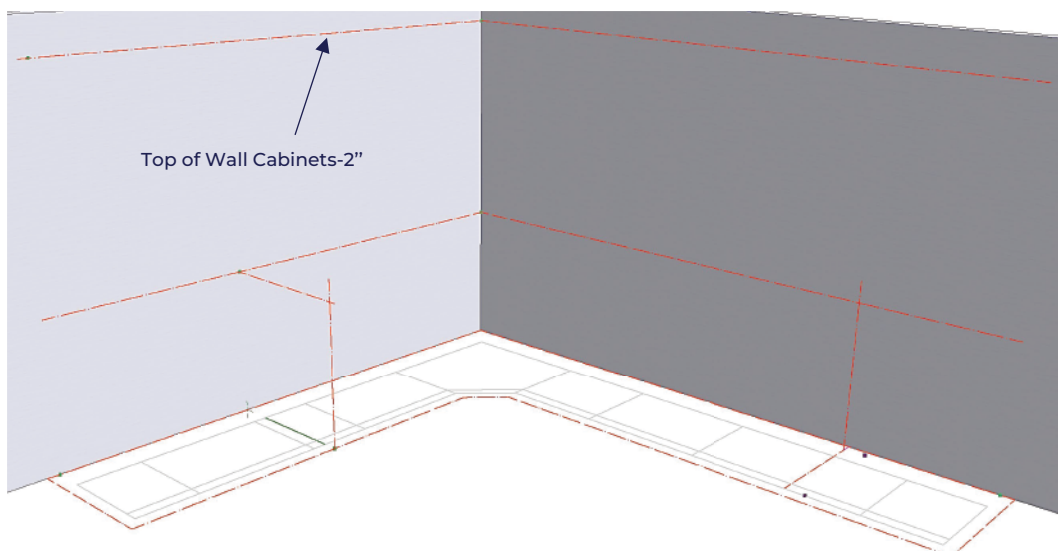

3. Install Upper Wall Cabinets

3.1. Install wall cabinet cleats onto the line established in Step 2.10 of layout instructions above. Center each cleat on the left-to-right location of its mating cabinet. Cleat may be shifted left or right up to $3/4$ " to enable fastening to the wall framing. If studs cannot be located using the supplied hole pattern, drill new holes or use heavy duty drywall anchors as needed. For walls with significant surface waviness, shims may be used at some connection points to maintain straightness of the cleats.

3.2. Hang each wall cab on its cleat. Slide left or right into the correct position.

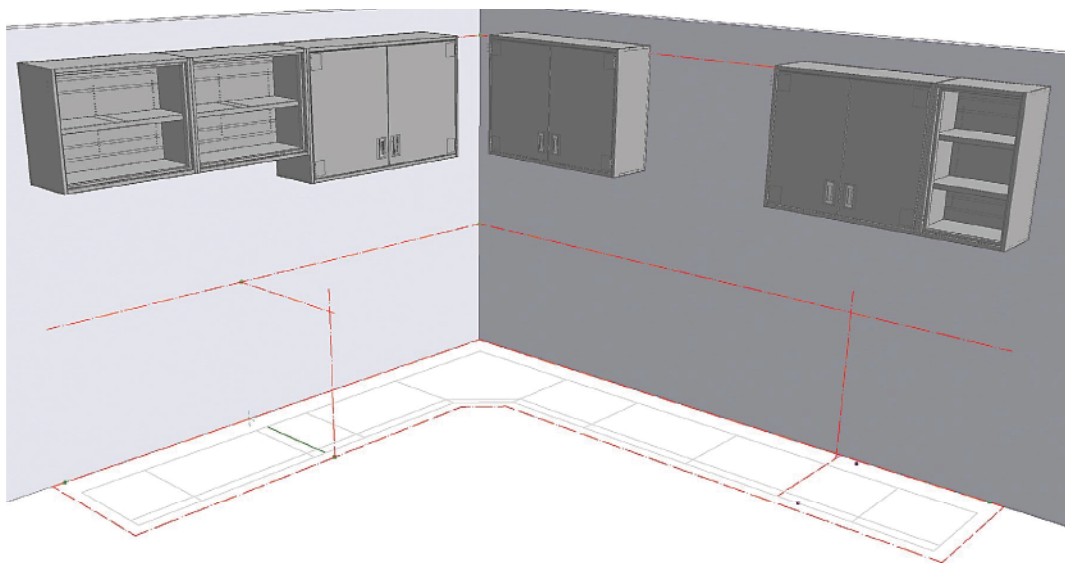
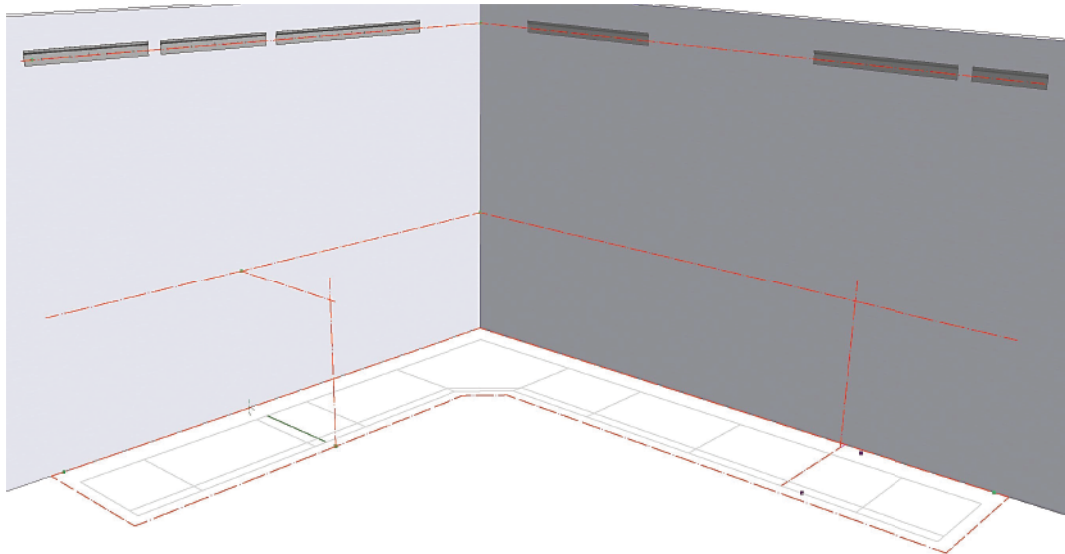

3.3. Clamp cabinet fronts tightly and fasten cabinets together using self-tapping screws. Hide the screws at top and bottom, near the front. To help hide the screws, false bottom panels need to be removed.

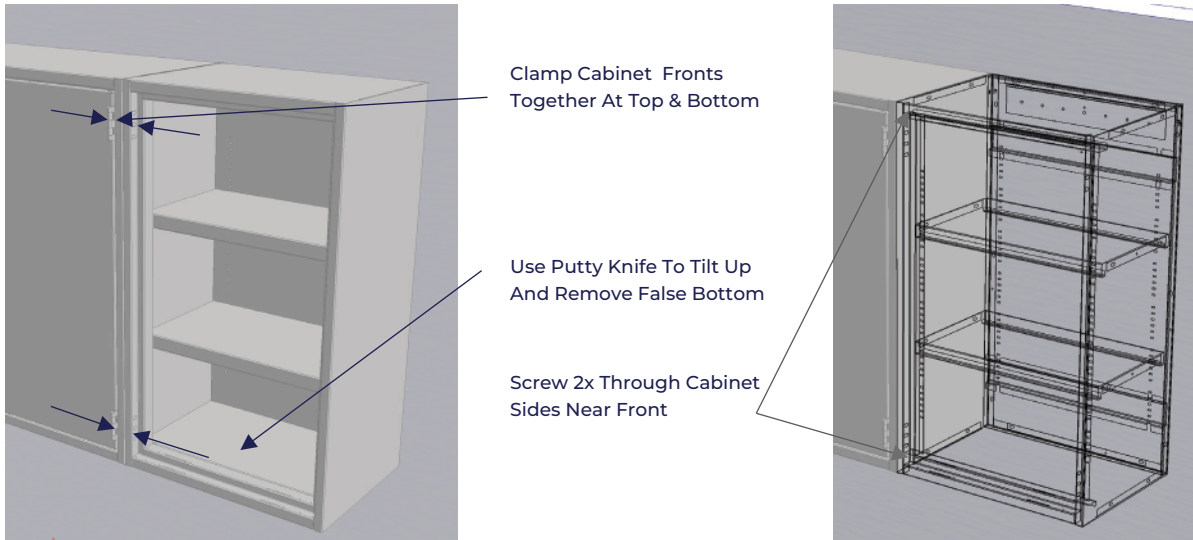

3.4. Layout and drill through the cabinet back to fasten upper cabinets to the wall framing. Back support hats are centered ~5" from the top and bottom. Locate screws in the center of this hat to minimize deformation of the back panel. Fasten to every stud where possible.

3.5. Check plumbness of the front faces of the wall cabinets. Loosen screws and insert shims between the wall and the top or bottom of the cabinet to adjust as needed.

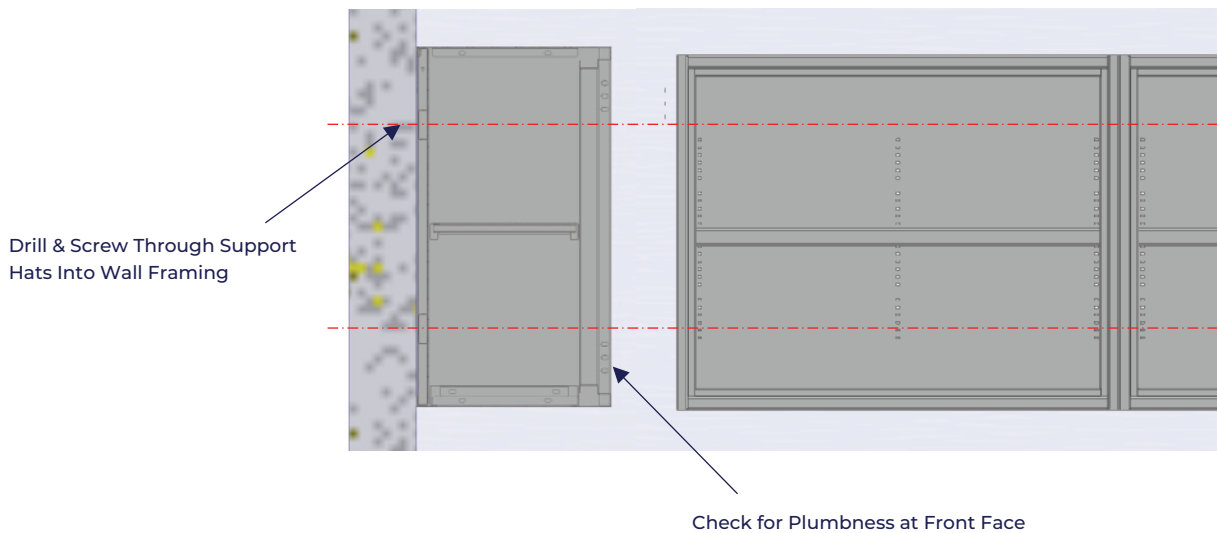

4. Install Base Cabinets

Cabinets

4.1. Install countertop support angle along the line established in Step 2.4 of layout instructions above. The angle need to be fastened to studs where possible but need not be fully continuous. Gaps up to 16" are permissible.

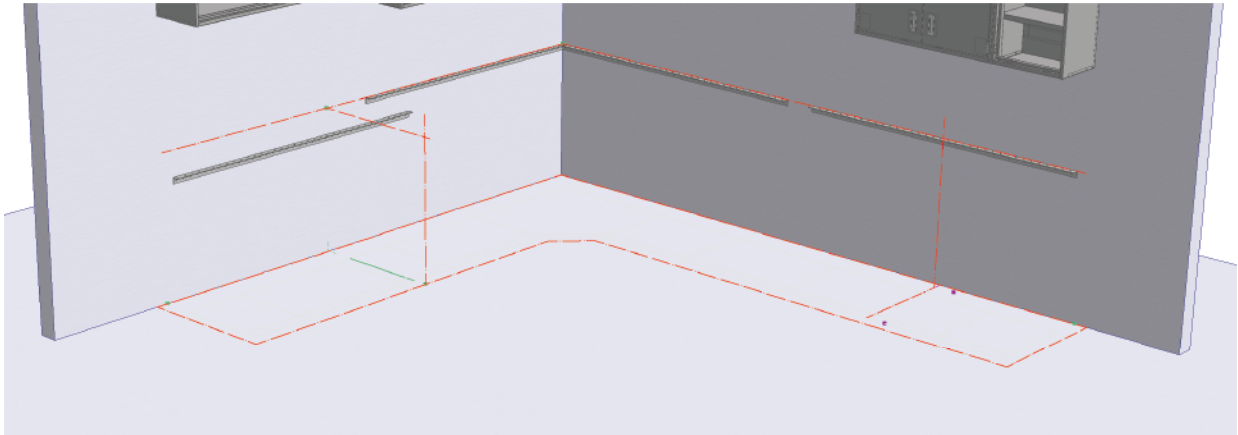

4.2. Place the first base cabinet in its final position as established in Step 2.9. Label, remove, and set aside any drawers for access to the cabinet interior. Also, if present, remove the bottom panel for access to the leveling feet.

4.3. Level the cabinet by turning the four leveling feet.

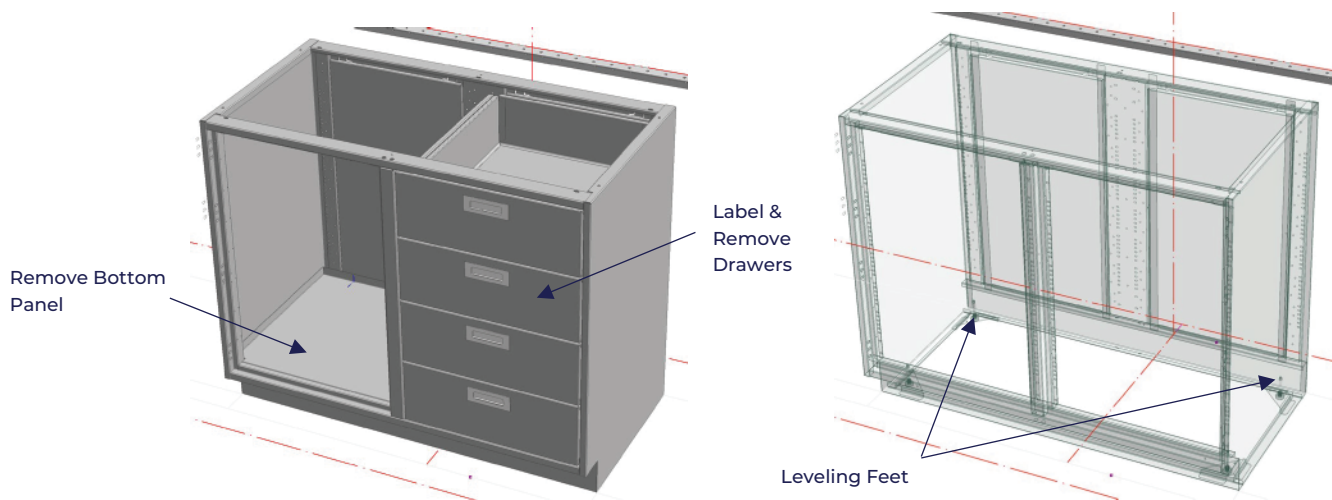

4.4. Continue placing and leveling the remaining base cabinets. Clamp cabinet fronts and fasten cabinets together using self-tapping screws. Hide screws in the toekick area and under the top rail.

4.5. Fix the cabinet system to the wall by fastening blocks between the backs of cabinets and the countertop support angle. 2x4 framing lumber or 3-4" strips of ¾" plywood work best. One block every 2 to 4ft should be sufficient. Locate blocks to avoid removable back panels of cabinets. The cabinets can also be fastened to the floor through the toekick and side panels. Use appropriate fasteners for your flooring material.

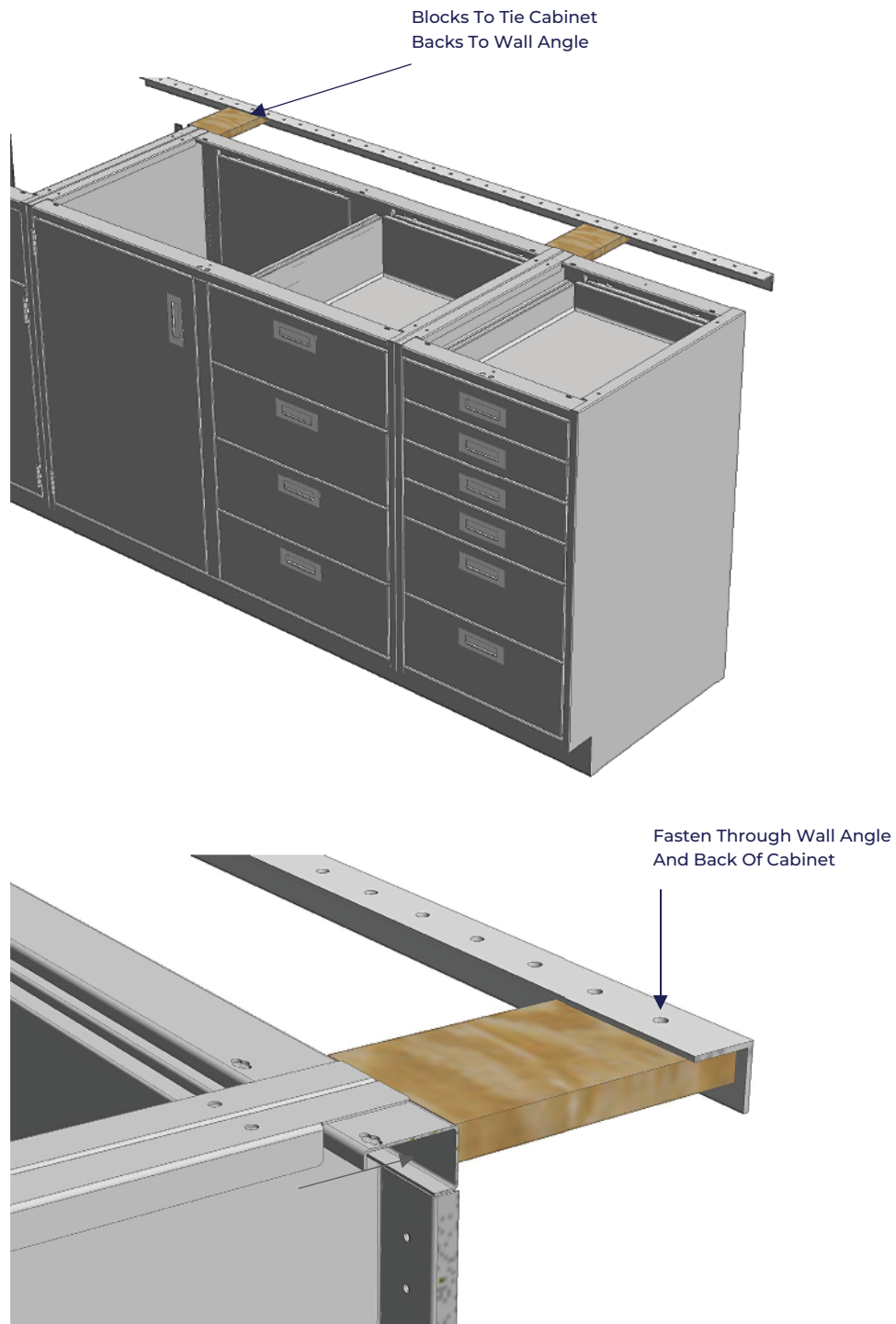

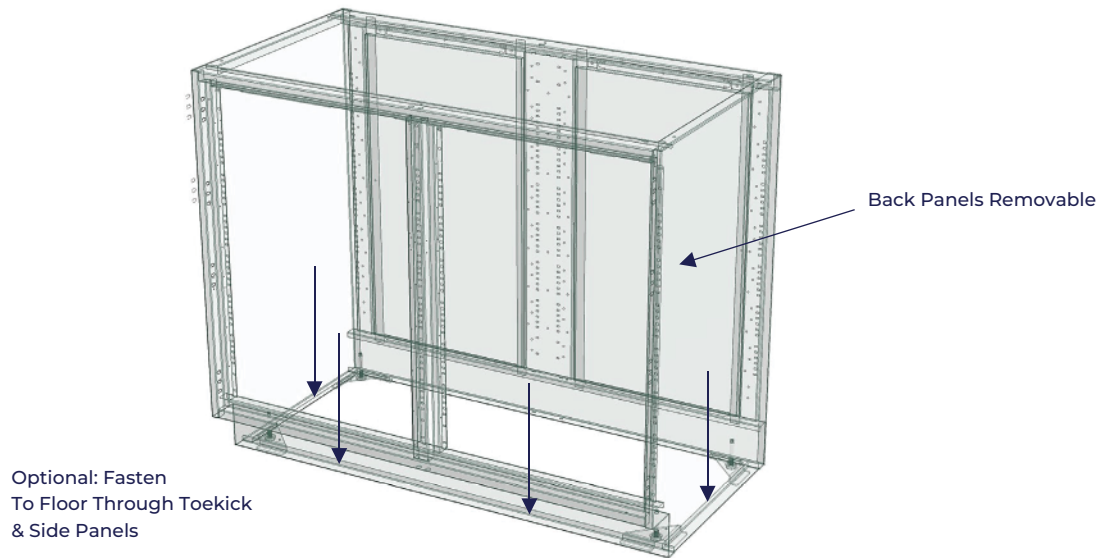

4.6. Reinstall bottom panels. Leave drawers out for installation of countertops.

Aprons & Knee Panels

4.7. Fasten aprons through cabinet sides using self-tapping screws.

4.8. Fasten toe panel to neighboring cabinets using self-tapping screws.

4.9. Drop knee panel onto toe panel and fix top using spring clips.

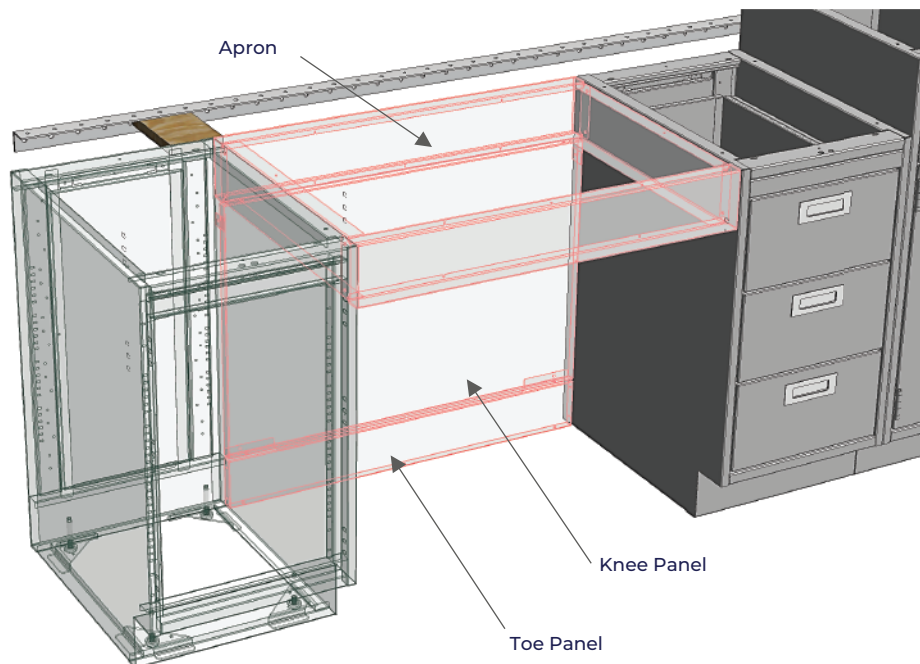

4.10. ADA knee panels are removable to preserve access to plumbing. Attach using spring clips screwed to neighboring cabinets or pedestal legs. If your project includes a tube frame as extra support beneath the sink, set it back far enough to clear the upper spring clips.

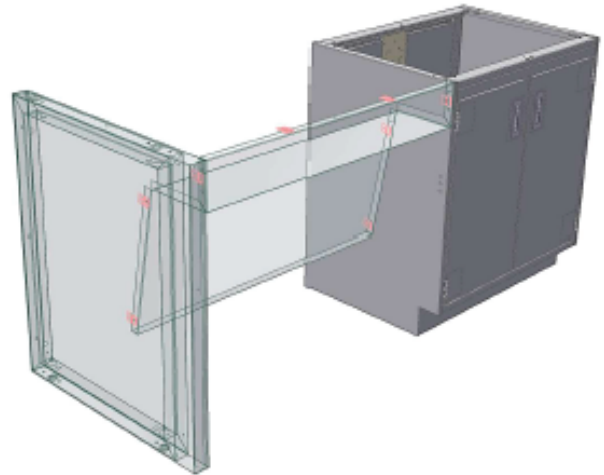

Pedestals

Pedestals with toekicks are supplied with a left or right finished side. The opposite (non-finish) side includes a removable panel. Pedestals without toekick cutouts are reversible and may be installed with the finish side facing either direction. To reverse orientation, relocate the leveling feet to the opposite end and flip the pedestal. Pedestals are normally fastened to aprons. To fasten to wall or floor, remove side access panel and screw through the frame.

Sink Supports

Sink cabinets include an array of holes to house sink hanger rods. Hook the 4 hanger rods into these holes to provide optimum support for the sink. Adjust the nuts up and down on the threaded rod until the sink is fully supported by the seat channel. Lock the nuts when complete.

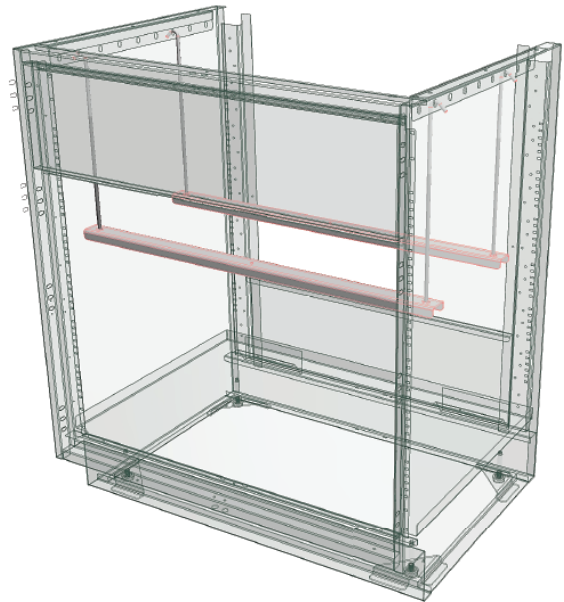

Rear Fillers

4.11. Stack 2 filler slip angles together. Use the mating filler piece to create a slip gap between the angles. This gap will receive the filler panel later.

4.12. Attach slip angle pair to wall through provided slots.

4.13. Scribe & trim filler as needed.

4.14. Attach filler panel to cabinet back using self-tapping screws or spring clips.

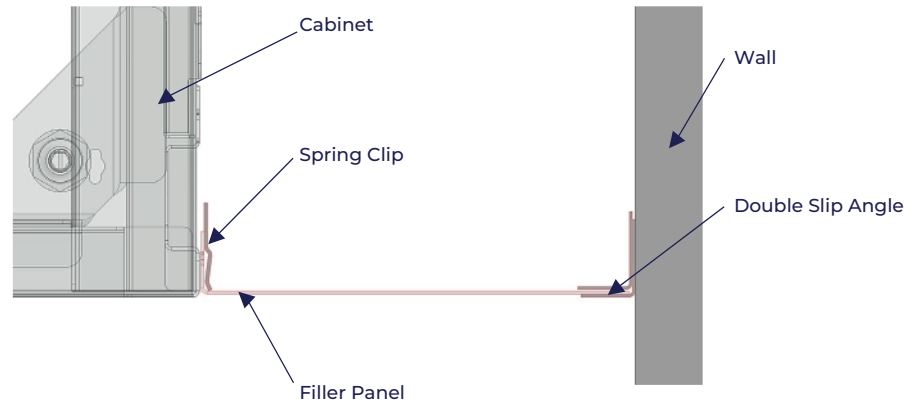
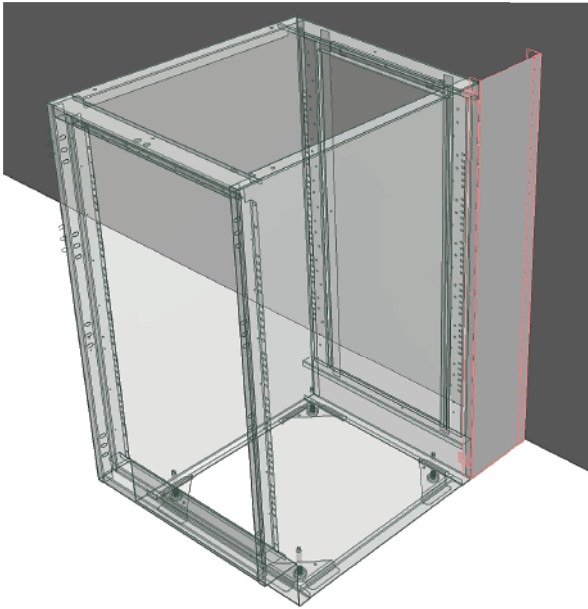

4.15. Front Fillers

4.16. Attach slip angles and filler as with rear fillers above.

4.17. Trim toekick angle to fit between cabinet and wall. Leave long and use sheet

C-Fillers

4.17. Attach filler panel between cabinets using self-tapping screws or spring clips.

Corner Fillers

4.19. Attach filler panel between cabinets using self-tapping screws or spring clips. 4.20. Trim toekick angle to fit between cabinets. Leave long and use sheet metal hand seamer tool to form wall flanges as needed. Attach using screws or spring clips.

5. Install Countertops

- 5.1. Position countertops per shop drawings. Trim and notch around walls and columns as needed. Refer to countertop manufacturer's installation documents for proper handling and processing.
- 5.2. Fasten countertops through slots in cabinet top rails. Use appropriate fasteners for your countertop material.
- 5.3. Reinstall drawers removed in Step 4.2 of base cabinet installation.

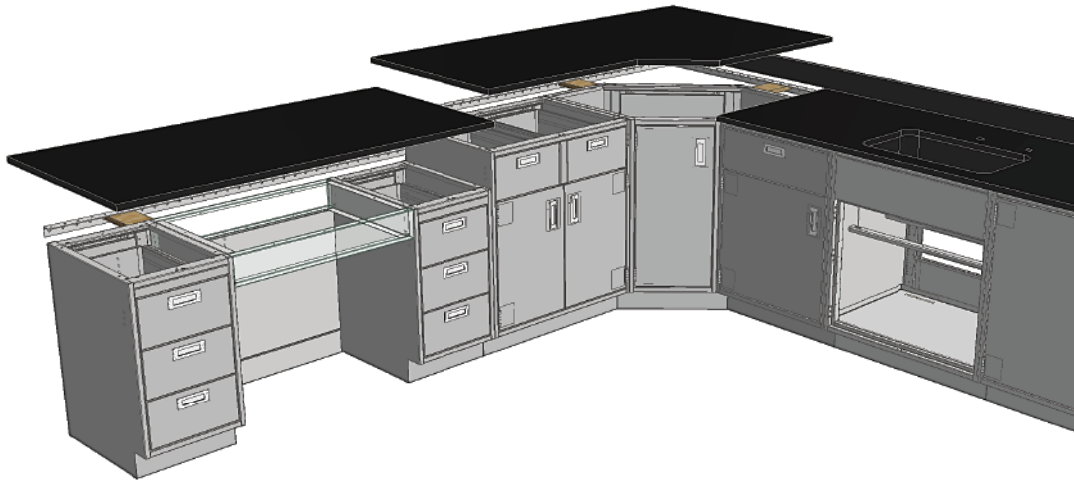

Fasten Countertops Through
Slots At Front & Back

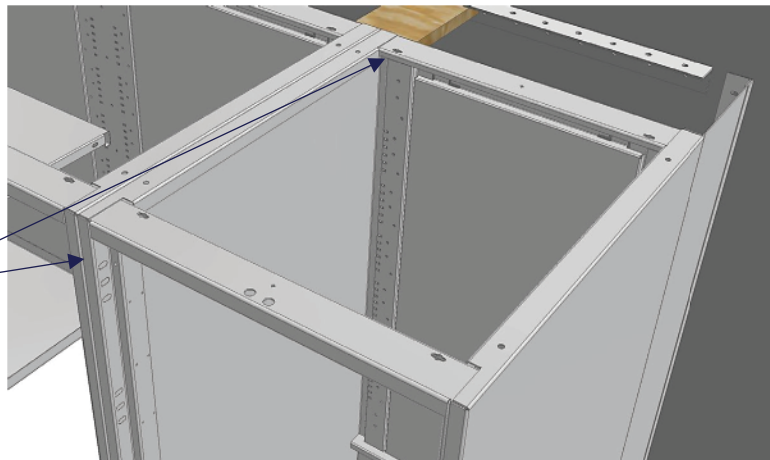

6. Final Alignment

All drawer and door fronts have been aligned at the factory based on a level and square base cabinet. Since field conditions can be different, some final adjustment of the fronts may be necessary.

- 6.1.** Loosen (but do not remove) screws between drawer front and drawer box. Loosen screws between drawer box and pull handle.
- 6.2.** Slide drawer front up or down, left or right.
- 6.3.** Retighten screws.

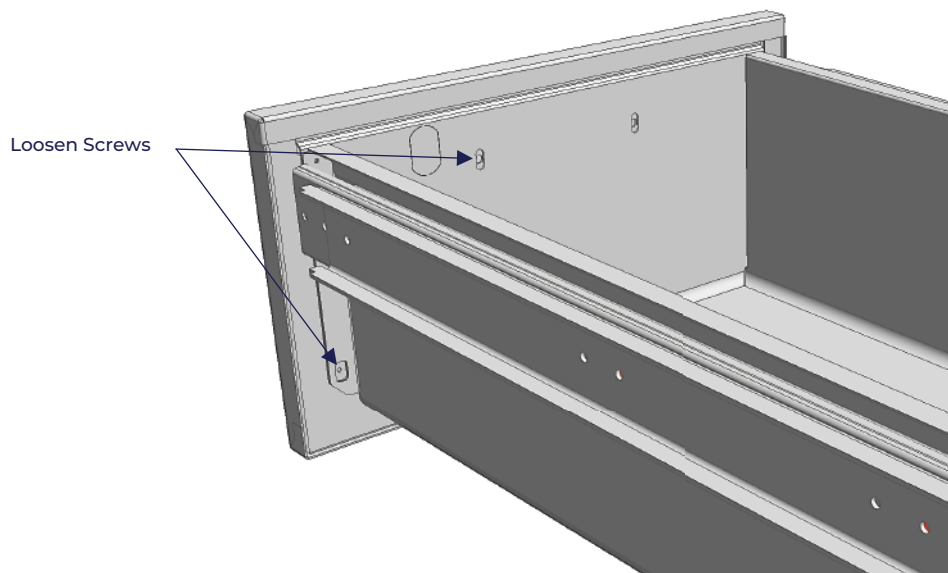

Doors

- 6.4.** Loosen (but do not remove) screws between hinges and the cabinet side.
- 6.5.** Adjust doors up or down, in or out.
- 6.6.** Retighten screws.
- 6.7.** To increase the gap between the door and the cabinet, open the door slightly and place a heavy wire tool or hex wrench between the hinge leaves. Lightly close the door against the tool to flex the hinge knuckle towards the interior of the cabinet.
- 6.8.** To decrease the gap, lightly tap the hinge knuckle toward the cabinet side using a soft mallet and block. Fine shims may also be inserted behind the hinge's jamb leaf to enable tilting of the hinge knuckle relative to the cabinet.

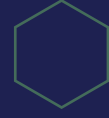

 **FORMASPACE**

 800.251.1505

 hello@formaspace.com

 formaspace.com

